

2-CONDUCTOR SUB-MINIATURE PLUGS

2.5 - 2極超小形単頭プラグ

No.MP-101MH (2.5 -2極)

MONO SCREW PART: PLASTICS

No.MP-101A (2.5 -2極)

MONO SCREW PART: METAL

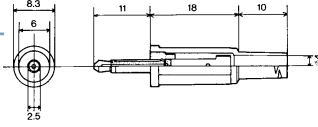

No.MP-101ML (2.5 -2極)

MONO SCREW PART: PLASTICS

No.MP-101MLA

MONO SCREW PART: METAL

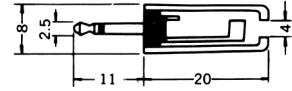

No.MP-101MR (2.5 -2極)

SCREW PART: PLASTICS
MONO



No.MP-101C (2.5 -2極)

MONO w/shielded handle

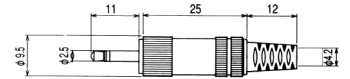

No.MC-25MN (2.5 -2極)

SUB-MINIATURE PLUG WITH 1.8M LONG CABLE
2-CONDUCTOR



No.MP-022LN (2.5 -2極)

MONO

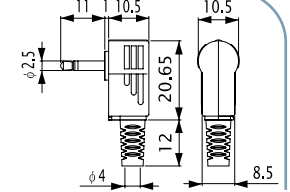

No.MC-25MNL (2.5 -2極)

SUB-MINIATURE RIGHT ANGLE PLUG WITH 1.8M LONG CABLE
2-CONDUCTOR



2-CONDUCTOR SUB-MINIATURE JACKS

2.5 - 2極超小形単頭ジャック

No.MJ-165 (2.5 -2極)

SUB-MINIATURE INLINE JACK
MONO

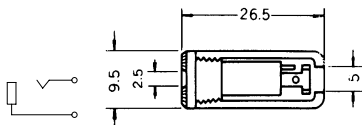

No.MJ-165A (2.5 -2極)

SUB-MINIATURE INLINE JACK
MONO

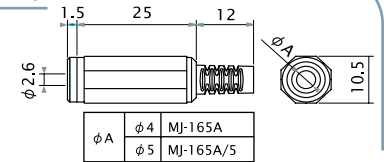

No.MJ-0252S (2.5 -2極)

2-CONDUCTOR SUB-MINIATURE INLINE JACK
MONO

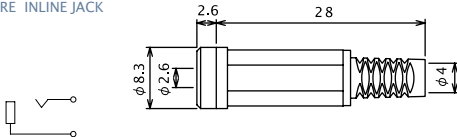

No.MJ-4625M (2.5 -2極)

2-CONDUCTOR SUB-MINIATURE JACK FOR P.C.B
MONO

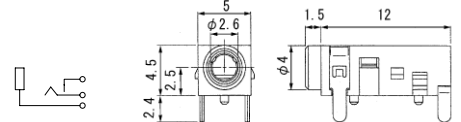

No.MJ-2625 (2.5 -2極)

2-CONDUCTOR SUB-MINIATURE JACK FOR P.C.B
MONO

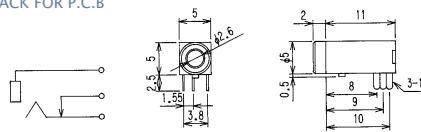

No.MJ-147D (2.5 -2極)

2-CONDUCTOR SUB-MINIATURE JACK FOR P.C.B
MONO

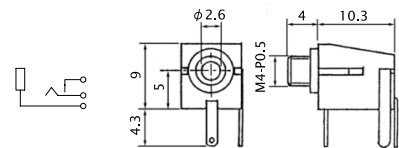

No.MJ-3425M (2.5 -2極)

2-CONDUCTOR SUB-MINIATURE JACK FOR P.C.B
MONO

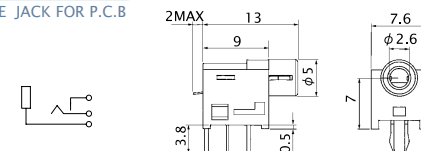

No.MJ-4125M (2.5 -2極) SMT

2-CONDUCTOR SUB-MINIATURE JACK FOR P.C.B
MONO

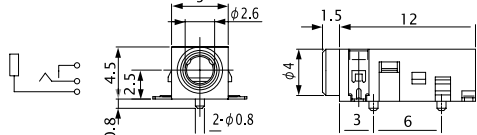

2-CONDUCTOR SUB-MINIATURE JACKS

2.5 - 2極超小形単頭ジャック

No. MJ-5325M (2.5 -2極) SMT

2-CONDUCTOR SUB-MINIATURE JACK FOR P.C.B MONO

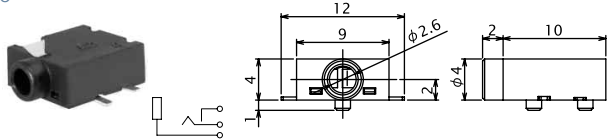

No. MJ-255 (2.5 -2極)

PANEL MOUNT SUB-MINIATURE JACK MONO

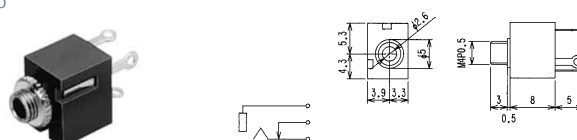

No. MJ-165H (2.5 -2極)

PANEL MOUNT SUB-MINIATURE JACK MONO

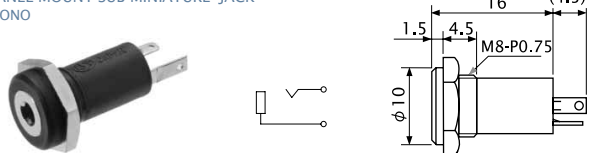

No. MJ-165SP (2.5 -2極)

SNAP-IN MOUNT SUB-MINIATURE JACK MONO

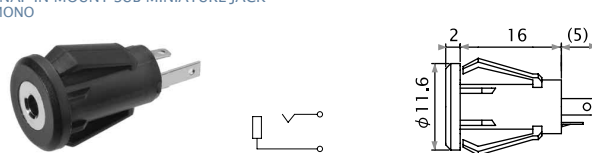

3-CONDUCTOR SUB-MINIATURE PLUGS

2.5 - 3極超小形単頭プラグ

No. MP-026L (2.5 -3極)

3-CONDUCTOR SUB-MINIATURE PLUG w/shielded handle STEREO

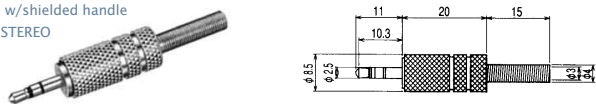

No. MP-025MH (2.5 -3極)

3-CONDUCTOR SUB-MINIATURE PLUG STEREO

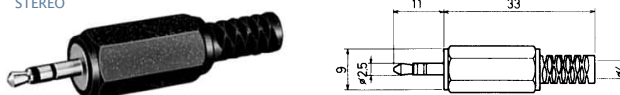

No. MC-25STL (2.5 -3極)

SUB-MINIATURE RIGHT ANGLE PLUG WITH 1.8M LONG CABLE 3-CONDUCTOR



No. MP-023LN (2.5 -3極)

3-CONDUCTOR SUB-MINIATURE RIGHT ANGLE PLUG STEREO

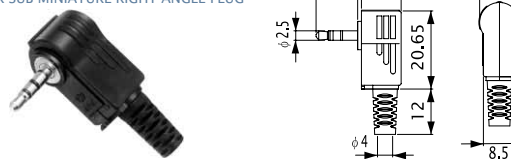

3-CONDUCTOR SUB-MINIATURE JACKS

No. MC-25ST (2.5 -3極)

SUB-MINIATURE PLUG WITH 1.8M LONG CABLE 3-CONDUCTOR



No. MJ-072 (2.5 -3極)

SUB-MINIATURE INLINE JACK STEREO

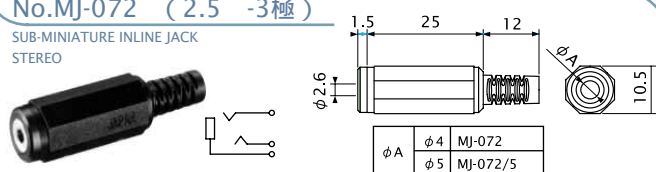

2.5 - 3極超小形単頭ジャック

No. MJ-0253S (2.5 -3極)

3-CONDUCTOR SUB-MINIATURE INLINE JACK STEREO

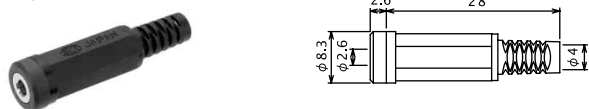

No. MJ-071 (2.5 -3極)

SUB-MINIATURE INLINE JACK STEREO

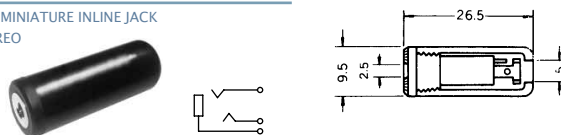

No. MJ-3625 (2.5 -3極)

3-CONDUCTOR SUB-MINIATURE JACK FOR P.C.B STEREO



No. MJ-2-348A0 (2.5 -3極) With Metal Sleeve

3-CONDUCTOR SUB-MINIATURE JACK FOR P.C.B STEREO

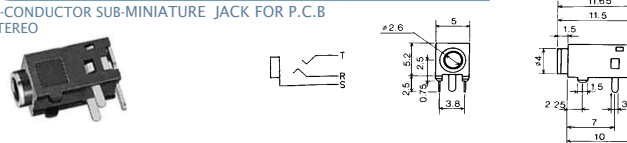

No. MJ-4625-3 (2.5 -3極)

3-CONDUCTOR SUB-MINIATURE JACK FOR P.C.B STEREO

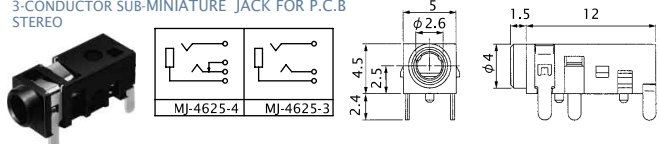

No. MJ-4625-4 (2.5 -3極)

3-CONDUCTOR SUB-MINIATURE JACK FOR P.C.B STEREO

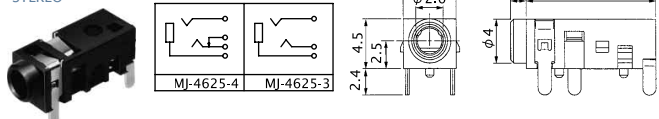

No. MJ-A18 (2.5 -3極)

3-CONDUCTOR SUB-MINIATURE JACK FOR P.C.B STEREO

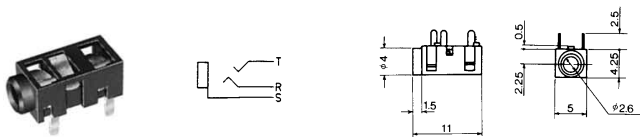

3-CONDUCTOR SUB-MINIATURE JACKS

2.5 - 3極超小形単頭ジャック

No. **MJ-2925-5** (2.5 -3極)

No. **MJ-2925A** (2.5 -3極)

No. **MJ-2925B** (2.5 -3極)

No. **MJ-2925-3** (2.5 -3極)

3-CONDUCTOR SUB-MINIATURE JACK FOR P.C.B STEREO

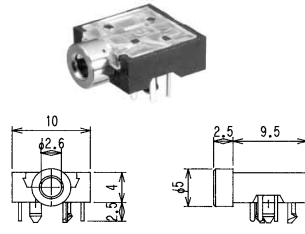
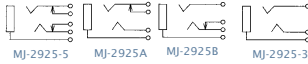

No. **MJ-4725-5** (2.5 -3極)

No. **MJ-4725A** (2.5 -3極)

No. **MJ-4725B** (2.5 -3極)

No. **MJ-4725-3** (2.5 -3極)

3-CONDUCTOR SUB-MINIATURE JACK FOR P.C.B STEREO

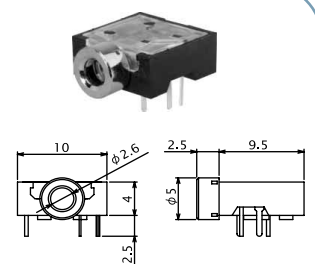
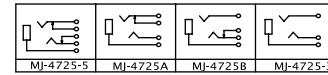

No. **M02-A04A0** (2.5 -3極)

3-CONDUCTOR SUB-MINIATURE JACK FOR P.C.B STEREO

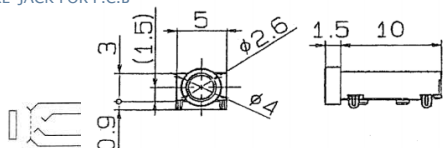

No. **M02-909A0** (2.5 -3極) SMT

3-CONDUCTOR SUB-MINIATURE JACK FOR P.C.B STEREO

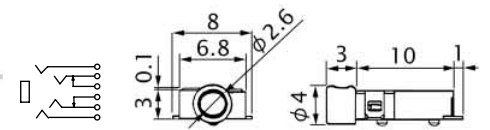

No. **MJ-7325** (2.5 -3極) SMT

3-CONDUCTOR SUB-MINIATURE JACK FOR P.C.B STEREO

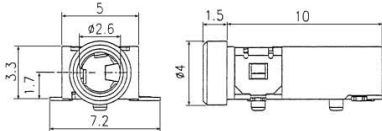

No. **MJ-4225-3** (2.5 -3極) SMT

No. **MJ-4225-5** (2.5 -3極) SMT

3-CONDUCTOR SUB-MINIATURE JACK FOR P.C.B STEREO

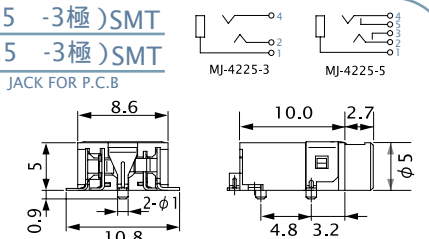

No. **MJ-4125-3** (2.5 -3極) SMT

No. **MJ-4125-4** (2.5 -3極) SMT

3-CONDUCTOR SUB-MINIATURE JACK FOR P.C.B STEREO

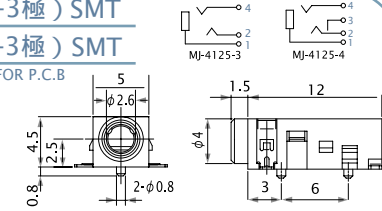

No. **MJ-070N** (2.5 -3極)

PANEL MOUNT SUB-MINIATURE JACK STEREO

No. **MJ-070N0** (2.5 -3極)

SUB-MINIATURE JACK FOR P.C.B STEREO WITHOUT SCREW THREAD

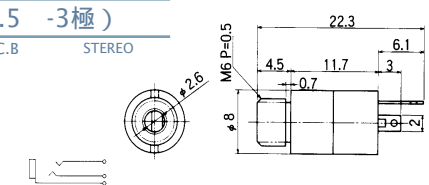

No. **MJ-5325-5** (2.5 -3極)

No. **MJ-5325A** (2.5 -3極)

No. **MJ-5325B** (2.5 -3極)

No. **MJ-5325-3** (2.5 -3極)

3-CONDUCTOR SUB-MINIATURE JACK FOR P.C.B STEREO

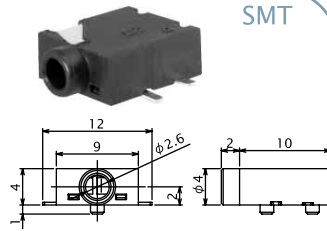
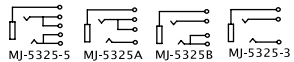

No. **MJ-071SP** (2.5 -3極)

SNAP-IN MOUNT SUB-MINIATURE JACK STEREO

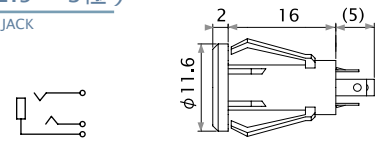

No. **MJ-8925** (2.5 -3極) SMT

3-CONDUCTOR SUB-MINIATURE JACK FOR P.C.B STEREO

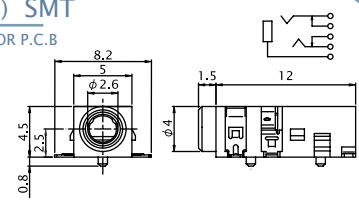

No. **MJ-071H** (2.5 -3極)

3-CONDUCTOR SUB-MINIATURE JACK STEREO

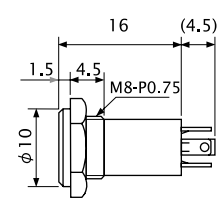



AUDIO PHONE PLUGS & JACKS

4-CONDUCTOR SUB-MINIATURE PLUGS & JACKS

2.5 - 4極超小形単頭プラグ・ジャック

No.MP-425 (2.5 -4極)

SUB-MINIATURE PLUG
4-CONDUCTOR

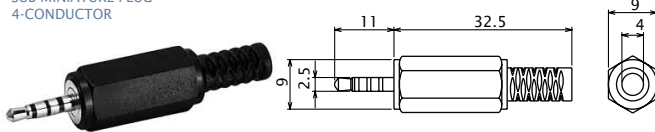

No.MP-425LN (2.5 -4極)

SUB-MINIATURE RIGHT ANGLE PLUG
4-CONDUCTOR

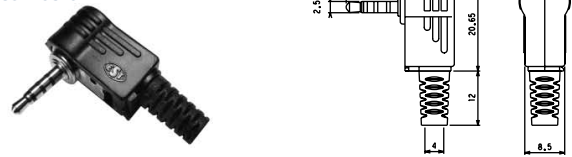

No.MC-4250 (2.5 -4極)

SUB-MINIATURE PLUG WITH 1.8M LONG CABLE
4-CONDUCTOR



No.MJ-0254S (2.5 -4極)

SUB-MINIATURE INLINE JACK
4-CONDUCTOR

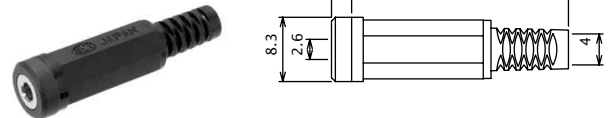

No.MC-4250L (2.5 -4極)

SUB-MINIATURE RIGHT ANGLE PLUG WITH 1.8M LONG CABLE
4-CONDUCTOR



No.MJ-068 (2.5 -4極)

SUB-MINIATURE INLINE JACK
4-CONDUCTOR

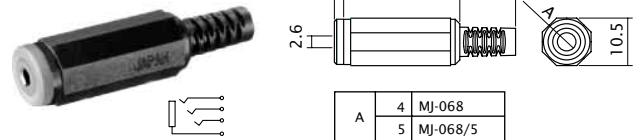

No.MJ-4225-4 (2.5 -4極)

No.MJ-4225-6 (2.5 -4極)

No.MJ-4225-A (2.5 -4極)

No.MJ-4225-B (2.5 -4極)

SUB-MINIATURE JACK FOR P.C.B
4-CONDUCTOR

SMT

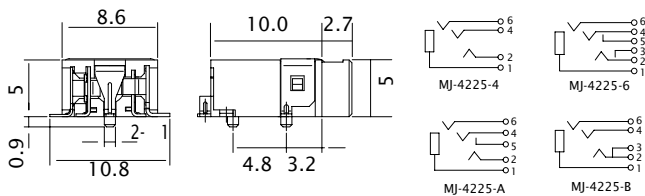

No.MJ-069 (2.5 -4極)

PANEL MOUNT SUB-MINIATURE JACK
4-CONDUCTOR

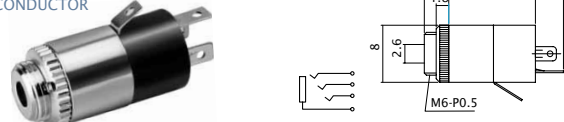

No.MJ-068H (2.5 -4極)

PANEL MOUNT SUB-MINIATURE JACK
4-CONDUCTOR

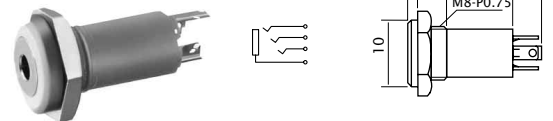

No.MJ-068SP (2.5 -4極)

SNAP-IN MOUNT SUB-MINIATURE JACK
4-CONDUCTOR

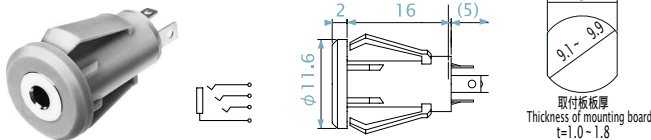

No.MC-254 (2.5 -4極)

SUB-MINIATURE PLUG WITH 1.8M LONG CABLE
4-CONDUCTOR



No.M19-442A (2.5 -4極)

SUB-MINIATURE PLUG FOR MOLDING
4-CONDUCTOR

