

☉ If you need Indicator, The part number is: LAS2GQH-E/△/▲/○/☆

☉ Install diameter: Φ 16mm

☉ Switch Max Rating: Ith:3A, Ui:250V

☉ Button shape: High Flat head Ring illuminated

☉ Contact Configuration(□): 1NO1NC(11)/ 2NO2NC(22)

☉ Operation Type(■): Momentary / Latching(Z)

☉ LED Color(△): **R** **G** **Y** **O** **B** **W**

☉ LED Voltage(▲): 6V/12V/24V/110V/220V

☉ Crust material(○): Stainless steel(S)/
Nickel plated brass(N)/Aluminium anodized(A)

☉ IP Rating(☆): IP40/IP67(FP),IK09

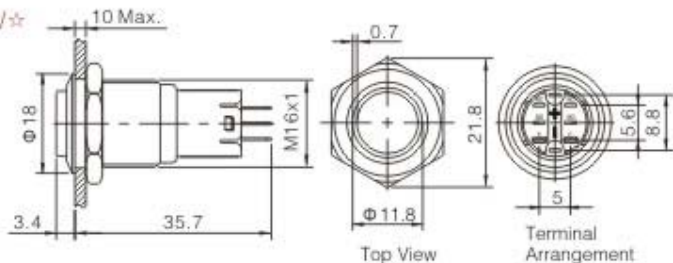

LAS2GQH-□■E/△/▲/○/☆

Terminal Type	Pin Terminal(1.8x0.4mm)	Material	Button	StainlessSteel/Aluminium alloy (Black)
Switching	C(single-breakfast-motion changeover contact)		Crust	Stainless steel/Nickel plated Brass/ Aluminium alloy black anodized
Panel Thickness	1 - 10mm		Base	PBT
Torque	0.6Nm	Operation Pressure	2.5~4N	
Mechanical Life	200,000 cycles	Operation Travel	About 2.8mm	
Electrical Life	50,000 cycles	RoHS	Made to order	