



# DC PLUGS & JACKS

PLUG TYPE 5.5x2.1 & 5.5x2.5 高容量タイプ High-capacity current type

## No. MJ-179PH

DC JACK FOR P.C.B.  
PLUG TYPE: 5.5x2.1 (DC12V 4A/2A\*SW接点部)  
(DC12V 4A/2A\* Switch part)

\* UL94V-0材使用  
Use of flame retardant material (UL94V-0)

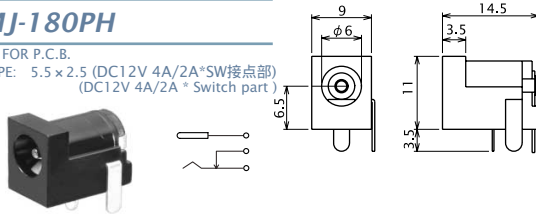

## No. MJ-180PH

DC JACK FOR P.C.B.  
PLUG TYPE: 5.5x2.5 (DC12V 4A/2A\*SW接点部)  
(DC12V 4A/2A\* Switch part)



## No. MP-121-1

5.5 x 2.1 DC PLUG FOR MOLDING  
(DC12V 4A)

\* センターコンタクトをフォーク端子（音叉形）形状とし、接触の安定化を図りました。  
Two-point contacts assure highly reliable electrical and mechanical connection

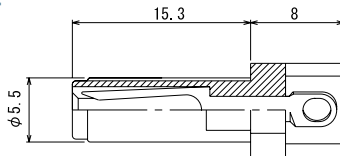

## No. MP-122-1

5.5 x 2.5 DC PLUG FOR MOLDING  
(DC12V 4A)

## No. MP-121CF

5.5 x 2.1 DC PLUG (DC12V 4A)

\* センターコンタクトをフォーク端子（音叉形）形状とし、接触の安定化を図りました。  
Two-point contacts assure highly reliable electrical and mechanical connection

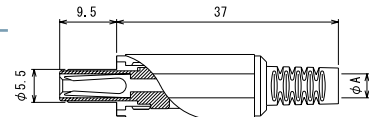

φA	φ4	MP-121CF	MP-122CF
	φ5	MP-121CF/5	MP-122CF/5

## No. MJ-R02

ON-OFFスイッチ付DCジャック  
DC POWER JACK WITH SWITCH  
PLUG TYPE: 5.5x2.1 (DC12V 2.5A)

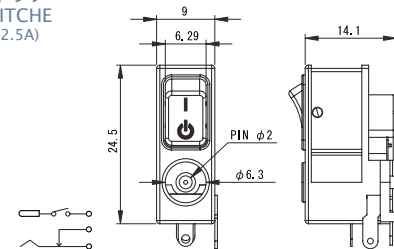

## No. MJ-S04

ON-OFFスイッチ付DCジャック  
DC POWER JACK WITH SWITCH  
PLUG TYPE: 5.5x2.1 (DC12V 2A)

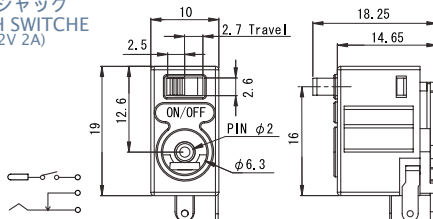

Marushin electric mfg. co., ltd