

RZ型微动开关

RZ Micro Switch

高精度和丰富品种著称最畅销的基本型开关
The most popular switch in high precision and rich types Reverse

(尺寸单位Size Unit : mm)



(针状按钮型Needle button type)

特点 Characteristic

1. 额定电流开闭容量为15A

Rated current capacity of opening and closing is 15A

15A 125, 250VAC, 1/8HP 125VAC, 1/4HP 250VAC
1/2A 125VDC, 1/4A 250VDC

2. 高精度、长寿命High precision and long life

- △ 动作位置(OP)精度高达±0.4mm(针状按钮型数值)
- △ Action seat(OP)precision reach 0.4mm (needle button type's value)

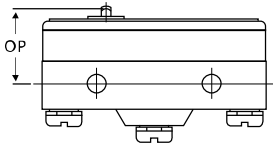

- △ 机械寿命：2000万以上(针状按钮型)
- △ Machinery life: more than 20,000,000 operation (needle button type)

接触形式 Contact type

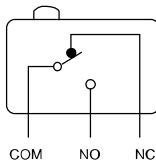

注：逆动作型(RZ-15GM□)的NO与NC是相反
Note: NO is the opposite to NC

3. 传动形式丰富，可依客户要求定制传动杠杆或传动装置。

Rich in drive types, can making the drive lever and gearing according to customer's require

传动形式 Drive types	针状按钮型 Needle button type	塞柱短按钮型 Fine plug column button type	塞柱短按钮型 Short plug column button type	面板安装式塞柱型 Panel installation of plug column type	面板安装式滚轮塞柱型 Panel installation of roller plug column type	簧片杠杆型 Flat spring lever type	簧片滚轮杠杆型 Flat spring roller lever type
示意图 Schematic diagram							
传动形式 Drive types	杠杆型 Lever type	滚轮杠杆型 Lever type roller lever type	单方向动作滚轮杠杆型 One-way action roller lever type	反向动作杠杆型 Reverse Action lever type	反向动作滚轮杠杆型 Reverse Action roller lever type	弹簧软杆型 Spring Soft rod type	
示意图 Schematic diagram							

安装孔加工尺寸 Installation hole processing dimension (mm)

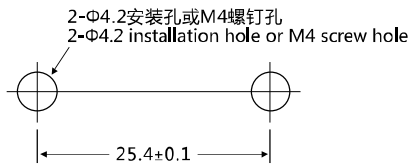

△ 面板安装型加工尺寸
△ Panel installation type of processing dimension

面板安装式塞柱型 Panel installation plug column type
面板安装式滚轮塞柱型 Panel installation roller plug type

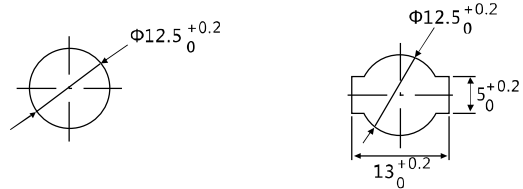

产品型号说明 Model description

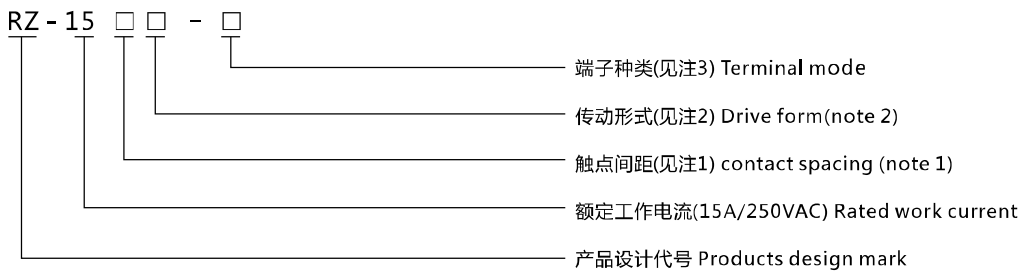

注Note 1 : 触点间距Contact spacing

- H : 0.25mm(高灵敏 微小负载用)
0.25mm(use for high-sensitivity micro-load)
- G : 0.5mm(标准standard)
- G : 1mm(高容量high capacity)
- E : 1.8mm(高容量high capacity)

注Note 3 : 端子种类Terminal type

- B : 杯口垫圈螺钉端子cup washers screw terminal
- B3 : 防滑内齿垫圈螺钉端子anti-slip teeth mat screw terminal
- B5 : 弹垫圈螺钉端子spring washers screw terminal

注Note 2 : 传动形式Drive form

- 无表示No indicated : 针状按钮型Needle button type
- S : 塞柱细按钮型Fine plug column button type
- D : 塞柱短按钮型short plug column button type
- Q : 面板安装式塞柱型panel installation of plug column type
- Q8 : 面板安装式长塞柱型panel installation of long plug column type
- Q22 : 面板安装式滚轮塞柱型panel installation of roller plug column type
- Q21 : 面板安装式交叉滚轮塞柱型
Panel installation of cross roller plug column type
- W54 : 交叉滚轮杠杆型Cross roller lever type
- W22S : 金属滚轮短杠杆型Metal roller lever type
- L : 簧片杠杆型Flat spring lever type
- L2 : 簧片滚轮杠杆型Flat spring roller lever type
- W21 : 短杠杆型Short lever type

W : 杠杆型Lever type

- W24 : **微量动作杠杆型Micro action lever type
- W78 : **微量动作钢丝杠杆型(OF小)
Micro action wire lever type(OF small)
- W52 : **微量动作钢丝杠杆型(OF大)
Micro action wire lever type(OF big)
- W22 : 滚轮短杠杆型Roller short lever type
- W2 : 滚轮杠杆型Roller short lever type
- W49 : 交叉滚轮短杠杆型Cross roller short lever
- W2S : 金属滚轮杠杆型Metal roller lever
- W25 : Φ20大个滚轮短杠杆型Φ20 dia roller short lever
- W2277 : 单方向动作滚轮杠杆型one-way action roller lever type
- R : *反向动作杠杆型Reverse Action lever type
- 注 : *只适用于Z15-G型的种类just for Z15-G type
**只适用于15-H型的种类just for 15-H type

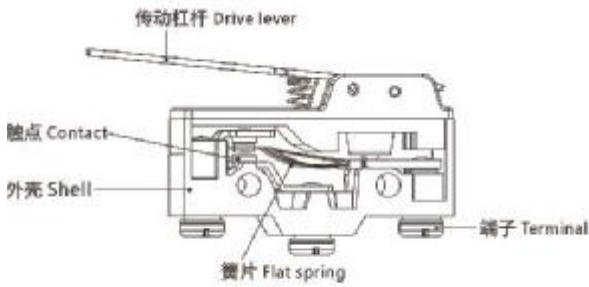
产品构造图 Product structure

接线部位尺寸 Wiring area size

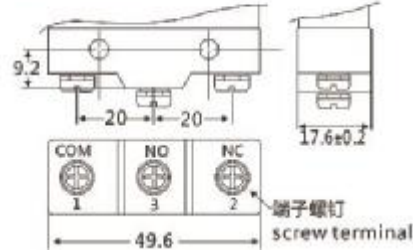
- △ 防滑齿垫(B3)型(另有杯口垫圈、弹垫圈型)
- △ Anti-slip teeth mat (B3) type (others are cup washers and spring washers)

额定值及性能概述 Rated value and performance

项目 Item	分类 Type	一般型 General type	弹簧软杆型 Soft flat spring lever type
允许操作速度 Operation speed		0.1mm~1m/秒(针状按钮型) 0.1mm-1m/s(needle button type)	1mm~1m/秒
允许通断频率 Action frequency	机械性 Mechanical	240次/分钟 240 operations/min	120次/分钟 120 operations/min
	电气性 Electrical	20次/分钟 20 operations/min	
绝缘电阻 Insulation resistance		100MΩ以上(用DC500V绝缘电阻计检测) 100mΩ min. (tested by 500VDC insulation ohmer)	
接触电阻(初始值) Contact resistance(initial value)		最大15mΩ 15mΩ Max	
耐击穿电压 Voltage-withstanding		非连接端子间 Non-connected and terminal 触点间距 Contact spacing G AC1, 000V 50/60Hz 1分钟/min 触点间距 Contact spacing H AC600V 50/60Hz 1分钟/min 触点间距 Contact spacing F,E AC1,500V 50/60Hz 1分钟/min	非连接端子间 Non-connected and terminal 触点间距Contact spacing G AC1,000V 50/60Hz 1分钟/min 触点间距Contact spacing H AC600V 50/60Hz 1分钟/min
		无电压金属件与各端子之间, 接地于各端子之间为AC2, 000V 50/60Hz 1分钟 Ground No-voltage metal part and terminal AC2,000V 50/60Hz 1min	
耐振性(针状按钮型) Vibration(needle type)	误动作 False action	双振幅1.5mm 10~55Hz(触点离开为1ms以下) 10-55HZ,1.5mm double amplitude (contact left is under 1ms)	
耐冲击性 Shock resistance	针状按钮型 Needle button type	最大300m/S ² (触点离开为1ms以下) Max.300m/S ² (contact left is under 1ms)	
	其它型 Other type	最大50m/S ² (触点离开为1ms以下) Max.50m/S ² (contact left is under 1ms)	
寿命 Life	机械寿命 Mechanical	针状按钮型 Needle button type 2,000万次以上(通断频率60次/分钟)(规定超程OT) 20,000,000 operations min(on-off frequency 60 operations/min)(overtravel OT)	100万次以上(通断频率60次/分钟) (规定超程OT) 10,000,000 operations min(on-off frequency 60 operations/min)(overtravel OT)
	电气寿命(阻性负载) Electrical resistance carry)	触点间距G,H 50万次以上(通断频率20次/分钟) Contact spacing G,H 500,000 operations min (on-off frequency 20 operations/min) 触点间距F 10万次以上(通断频率20次/分钟) Contact spacing F 100,000 operations min (on-off frequency 20 operations/min) 触点间距E 10万次以上(通断频率20次/分钟) Contact spacing E 100,000 operations min (on-off frequency 20 operations/min)	10万次以上(通断频率20次/分钟) 100,000 operations min(on-off frequency 20 operations/min)
使用环境温度、湿度 Ambient temperature and humidity		-25℃~+80℃(应无冻冰、凝露)在85%RH以下(+5~35℃左右) -25℃~+80℃(without frozen and dew),under 85%(about +5~35℃)	
触点材料 Contact material		AgNi合金; AgCdO合金(未在RoHS指令内) AgNi alloy; AgCdO alloy(Without meet the RoHS directive)	
重量 Weight		约 About 22~58g	约 About 42~48g

※注: 开关操作伴随有低速、高速和冲击, 或在高温多湿环境下使用时, 寿命及性能可能会因负载容量而显著降低, 因此敬请垂询。
 ※Note:When the switch works in low speed,high speed,shock or high temperature and heavy humidity,the life of switch will down bcz the loading capacity.
 This picture just for customer's references ,please inquiry for details when ordering.

图片展示 Pictures Pictures

<p>针状按钮型 Needle button type</p>  <p>RZ-15G-B3</p>	<p>塞柱细按钮型 Fine plug column button type</p>  <p>RZ-15GS-B3</p>	<p>塞柱短按钮型 Short plug column button type</p>  <p>RZ-15GD-B3</p>	<p>塞柱防溅按钮型</p>  <p>RZ-15GD55-B3</p>
<p>面板安装式塞柱型 Panel installation of plug column type</p>  <p>RZ-15GQ-B3</p>	<p>面板安装式滚轮塞柱型 Panel installation of roller plug column type</p>  <p>RZ-15GQ22-B3</p>	<p>面板安装式交叉滚轮塞柱型 Panel installation of cross roller plug column type</p>  <p>RZ-15GQ21-B3</p>	<p>面板安装式长塞柱型 Panel installation of long plug column type</p>  <p>RZ-15GQ8-B3</p>
<p>短杠杆型 Drive types</p>  <p>RZ-15GW21-B3</p>	<p>杠杆型 Drive types</p>  <p>RZ-15GW-B3</p>	<p>滚轮短杠杆型 Lever type roller lever type 铜轮 Copper roller</p>  <p>RZ-15GW22S-B3</p>	<p>滚轮杠杆型 Lever type roller lever type 铜轮 Copper roller</p>  <p>RZ-15GW2S-B3</p>
<p>滚轮短杠杆型 Lever type roller lever type 塑轮 Plastic roller</p>  <p>RZ-15GW22-B3</p>	<p>滚轮杠杆型 Lever type roller lever type 塑轮 Plastic roller</p>  <p>RZ-15GW2-B3</p>	<p>滚轮杠杆型(38.5mm) Roller lever type(38.5mm)</p>  <p>RZ-15GW23S-B3</p>	<p>Φ20大滚轮杠杆型 Φ20 Big roller lever</p>  <p>RZ-15GW25-B3</p>
<p>簧片杠杆型 Flat spring lever type</p>  <p>RZ-15GL-B3</p>	<p>簧片滚轮杠杆型 Flat spring roller lever type</p>  <p>RZ-15GL2S-B3</p>	<p>交叉滚轮短杠杆型 Cross roller short lever</p>  <p>RZ-15GW49S-B3</p>	<p>交叉滚轮杠杆型 Cross roller short lever</p>  <p>RZ-15GW54S-B3</p>

※注：本图册仅以触点间距规格，防滑齿垫圈型(-B3展示，另有H、F、E触点规格和杯口垫圈型(-B)、弹垫圈型(-B5)等规格，规格可供选择。客户订购时请说明，以保证正确购买。

※Note: The display pictures and model is examples by contact spacing specification, anti-slip teeth mat type(B3 display,others with H,F,E contact specification and sup washers type(-B) and spring washers(-B5) specification and so on.The specification can be chosen This picture just for customer' s references ,please inquiry for details when ordering.

图片展示 Pictures

<p>单方向动作滚轮杠杆型 One-way action roller lever type</p>  <p>RZ-15GW2277S-B3</p>	<p>钢丝杠杆型(63.5钢丝) Wire lever type (63.5wire)</p>  <p>RZ-15HW52-B3</p>	<p>钢丝杠杆型(110钢丝) Wire lever type (110wire)</p>  <p>RZ-15HW78-B3</p>	<p>微量动作杠杆型 Micro action lever type</p>  <p>RZ-15HW24-B3</p>
<p>加宽杠杆型 Wide lever type</p>  <p>RZ-15GW-B3(K)</p>	<p>反向动作杠杆型 Reverse action lever type</p>  <p>RZ-15GR-B3</p>	<p>杠杆带簧片型 Flat spring lever type</p>  <p>RZ-15GW-B3(3孔)</p>	<p>烫斗开关型(红) Iron switch (red) type</p>  <p>TD10</p>
<p>保护罩 Protective cover</p>  <p>AP-A</p>	<p>保护罩 Protective cover</p>  <p>AP-B</p>	<p>保护罩 Protective cover</p>  <p>AP-C</p>	<p>保护罩 Protective cover</p>  <p>AP-D</p>

RM型游戏机台面按钮系列 RM Type Game Table Button Series

 <p>RM-28</p>	 <p>RM-24(红)</p>	 <p>RM-24(绿)</p>	 <p>RM-24(蓝)</p>
--	---	--	---

※注：RM系列按钮可定制各种颜色，客户订购时敬请垂询，以保证正确购买。
 ※Note: All kinds of colors are available, pls inquiry about color when making order